



Excellent Choice

# New Next Dimension Series

## Drywall Return Instructions for Mulled Unit Application

### What you will need:

- Saw/Handsaw
- Utility Knife
- Pencil
- Hammer
- Wood Block

### Drywall Return Extrusion:

White 10127908: 1/2" – 11/16"

Clay 10127909: 1/2" – 11/16"



### Installation:

**Step 1.** Cut Drywall Return to appropriate length.

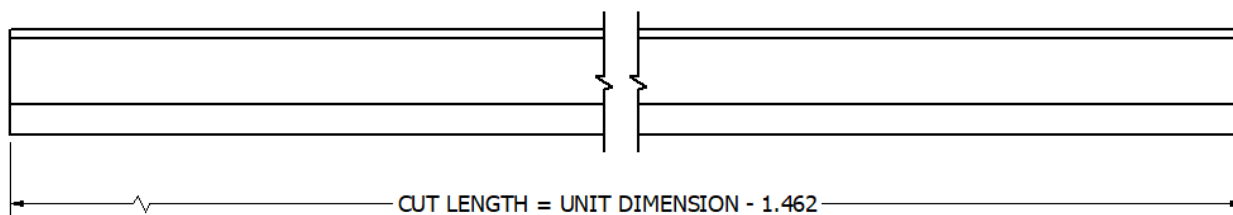

**Step 2.** Mark the centerline of the mull on the Drywall Return.

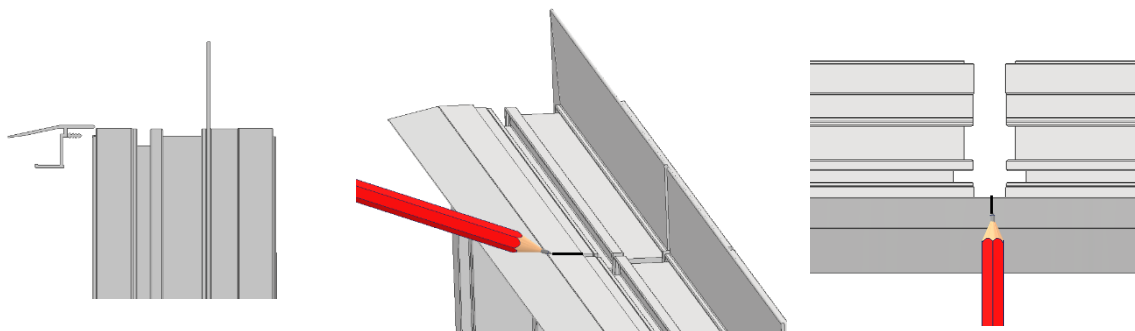

**Step 3.** Using a saw, or other cutting tool, cut two notches into the legs of the Drywall Return 1 inch apart (1/2" from each side of the centerline mark)

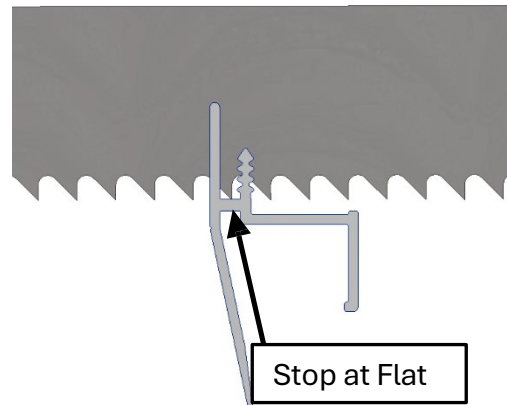
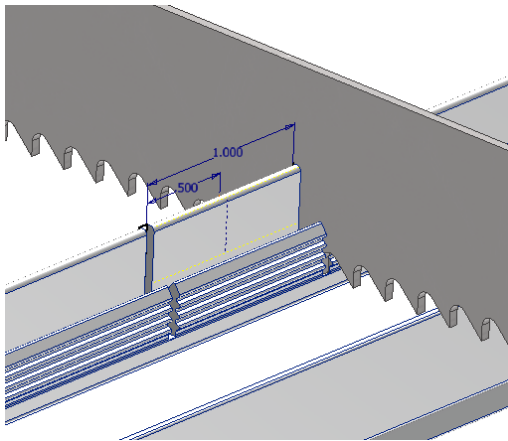

**Step 4.** Using a Utility Knife, scribe a line at the base of each leg.

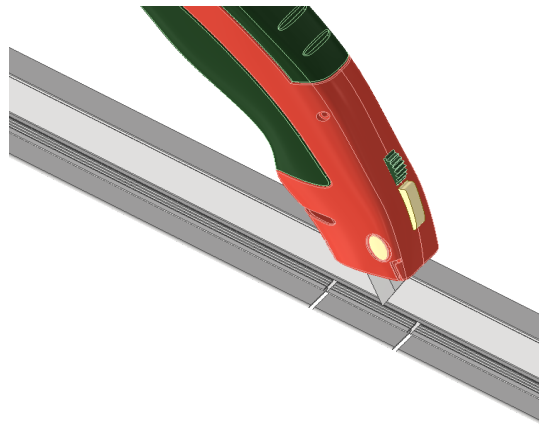

**Step 5.** Bend and break off both legs at the scribe mark.

**Step 6.** Press Drywall Return into the accessory groove on the window frame. If required, use a hammer with a wood block as shown below.

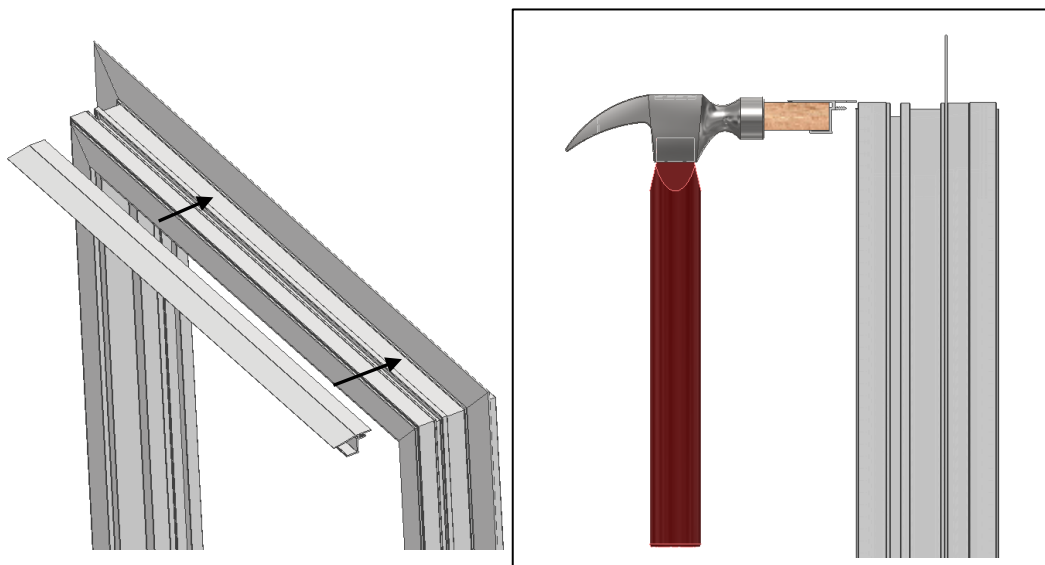

**Step 7.** Center drywall return on unit. Distance from edge of drywall return to edge of unit = 0.747"

