

WINDSOR WINDOWS & DOORS

PINNACLE CLAD 2" LVL MULLION

(WZ3)(IMPACT)

INSTALLATION NOTES:

- ONE (1) INSTALLATION ANCHOR IS REQUIRED AT EACH ANCHOR LOCATION SHOWN.
- THE NUMBER OF INSTALLATION ANCHORS DEPICTED IS THE MINIMUM NUMBER OF ANCHORS TO BE USED FOR PRODUCT INSTALLATION OF THE MAXIMUM SIZE LISTED.
- INSTALL INDIVIDUAL INSTALLATION ANCHORS WITHIN A TOLERANCE OF ±1/2 INCH (I.E., WITHOUT CONSIDERATION OF TOLERANCES). TOLERANCES ARE NOT CUMULATIVE FROM ONE INSTALLATION ANCHOR TO THE NEXT.
- SHIM AS REQUIRED AT EACH INSTALLATION ANCHOR WITH LOAD BEARING SHIM(S). MAXIMUM ALLOWABLE SHIM STACK TO BE 1/4 INCH. SHIM WHERE SPACE OF 1/16 INCH OR GREATER OCCURS. SHIM(S) SHALL BE CONSTRUCTED OF HIGH DENSITY PLASTIC OR BETTER.
- REFER TO SHEETS 2 & 3 FOR INSTALLATION DETAILS, ANCHOR SELECTION, AND ANCHOR REQUIREMENTS.
- MINIMUM EMBEDMENT AND EDGE DISTANCE EXCLUDE WALL FINISHES, INCLUDING BUT NOT LIMITED TO STUCCO, FOAM, BRICK VENEER, AND SIDING.
- INSTALLATION ANCHORS AND ASSOCIATED HARDWARE MUST BE MADE OF CORROSION RESISTANT MATERIAL OR HAVE A CORROSION RESISTANT COATING.
- FOR HOLLOW BLOCK AND GROUT FILLED BLOCK, DO NOT INSTALL INSTALLATION ANCHORS INTO MORTAR JOINTS. EDGE DISTANCE IS MEASURED FROM FREE EDGE OF BLOCK OR EDGE OF MORTAR JOINT INTO FACE SHELL OF BLOCK.
- INSTALLATION ANCHORS SHALL BE INSTALLED IN ACCORDANCE WITH ANCHOR MANUFACTURER'S INSTALLATION INSTRUCTIONS, AND ANCHORS SHALL NOT BE USED IN SUBSTRATES WITH STRENGTHS LESS THAN THE MINIMUM STRENGTH SPECIFIED BY THE ANCHOR MANUFACTURER.
- INSTALLATION ANCHOR CAPACITIES FOR PRODUCTS HEREIN ARE BASED ON SUBSTRATE MATERIALS WITH THE FOLLOWING PROPERTIES:
 - WOOD - MINIMUM SPECIFIC GRAVITY OF 0.55.
 - CONCRETE - MINIMUM COMPRESSIVE STRENGTH OF 3000 PSI.
 - CMU - STRENGTH CONFORMANCE TO ASTM C90.
 - STEEL - MINIMUM YIELD STRENGTH OF 33 KSI. MINIMUM GA. WALL THICKNESS

GENERAL NOTES:

- THE PRODUCT SHOWN HEREIN IS DESIGNED AND MANUFACTURED TO COMPLY WITH THE CURRENT EDITION OF THE FLORIDA BUILDING CODE (FBC) AND INTERNATIONAL BUILDING CODE (IBC), EXCLUDING HVHZ AND HAS BEEN EVALUATED ACCORDING TO THE FOLLOWING:
 - AAMA/WDMA/CSA 101/I.S.2/A440-08/11
 - AAMA 506-16
 - ASTM E1886-13
 - ASTM E1996-14
- ADEQUACY OF THE EXISTING STRUCTURAL CONCRETE/MASONRY AND 2X FRAMING AS A MAIN WIND FORCE RESISTING SYSTEM CAPABLE OF WITHSTANDING AND TRANSFERRING APPLIED PRODUCT LOADS TO THE FOUNDATION IS THE RESPONSIBILITY OF THE ENGINEER OR ARCHITECT OF RECORD FOR THE PROJECT OF INSTALLATION.
- 1X AND 2X BUCKS (WHEN USED) SHALL BE DESIGNED AND ANCHORED TO PROPERLY TRANSFER ALL LOADS TO THE STRUCTURE. BUCK DESIGN AND INSTALLATION IS THE RESPONSIBILITY OF THE ENGINEER OR ARCHITECT OF RECORD FOR THE PROJECT OF INSTALLATION.
- THE INSTALLATION DETAILS DESCRIBED HEREIN ARE GENERIC AND MAY NOT REFLECT ACTUAL CONDITIONS FOR A SPECIFIC SITE. IF SITE CONDITIONS CAUSE INSTALLATION TO DEVIATE FROM THE REQUIREMENTS DETAILED HEREIN, A LICENSED ENGINEER OR ARCHITECT SHALL PREPARE SITE SPECIFIC DOCUMENTS FOR USE WITH THIS DOCUMENT IN NON-HVHZ AREAS.
- APPROVED IMPACT PROTECTIVE SYSTEM **IS NOT REQUIRED** FOR THIS PRODUCT IN **ZONE 3 OR LESS**.
- APPROVED IMPACT PROTECTIVE SYSTEM **IS REQUIRED** FOR THIS PRODUCT IN **WIND ZONE 4**.
- MULLION MATERIAL: GLULAM LVL.

TABLE OF CONTENTS	
SHEET	SHEET DESCRIPTION
1	INSTALLATION & GENERAL NOTES
2	VERTICAL MULLION ASSEMBLIES
3	HORIZONTAL MULLION ASSEMBLIES
4	INSTALLATION DETAILS
5	1-WAY DESIGN PRESSURE TABLES - THROUGH INSTALLATION
6	2-WAY DESIGN PRESSURE TABLES - THROUGH INSTALLATION
7	1-WAY DESIGN PRESSURE TABLES - STRAP INSTALLATION
8	2-WAY DESIGN PRESSURE TABLES - STRAP INSTALLATION



WINDSOR WINDOWS
& DOORS
900 S. 19TH STREET.
WEST DES MOINES, IA 50265
PH: (515)223-6660 FAX: (515)224-1938

TITLE:
PINNACLE CLAD 2" LVL MULLION
(WZ3)(IMPACT)
INSTALLATION
& GENERAL NOTES

PREPARED BY:
BUILDING DROPS, INC.
398 E. DANIA BEACH BLVD., STE. 338
DANIA BEACH, FL 33004
PH: (954)399-8478
FAX: (954)744-4738
WEB: www.buildingdrops.com

REMARKS	BY	DATE
FBC 2017 UPDATE	LS	06/17
FBC 2020 UPDATE	LL	11/20
FBC 2023 UPDATE	MG	02/23

THE INSTALLATION DETAILS DESCRIBED HEREIN ARE GENERIC AND MAY NOT REFLECT ACTUAL CONDITIONS FOR A SPECIFIC SITE. IF SITE CONDITIONS CAUSE INSTALLATION TO DEVIATE FROM THE REQUIREMENTS DETAILED HEREIN, A LICENSED ENGINEER OR ARCHITECT SHALL PREPARE SITE SPECIFIC DOCUMENTS FOR USE WITH THIS DOCUMENT.

HERMES F. NORERO, P.E.
FLORIDA
BUILDING DROPS, INC.
398 E. DANIA BEACH BLVD. # 338
DANIA BEACH, FL 33004
FBPE CERT. OF AUTHORIZATION No. 29578

FL21905

DATE: 02.10.17

DWG. BY: LA	CHK. BY: SM
----------------	----------------

SCALE: NTS

DWG. #: WWD002

SHEET:

1

OF 8

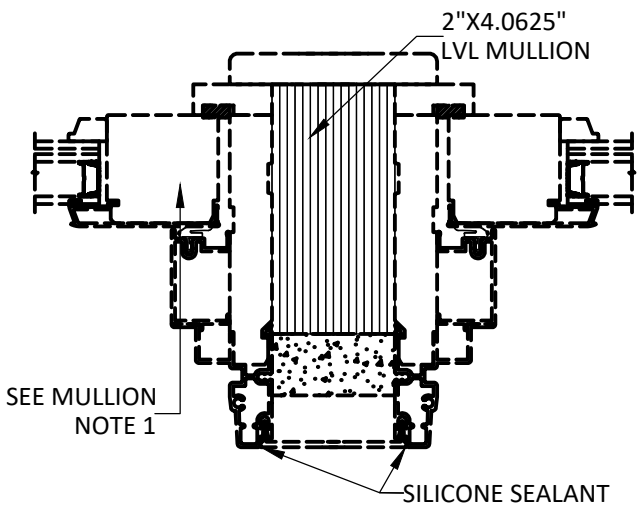

A
2
DUAL DOUBLE HUNG PIC.
VERTICAL MULLION

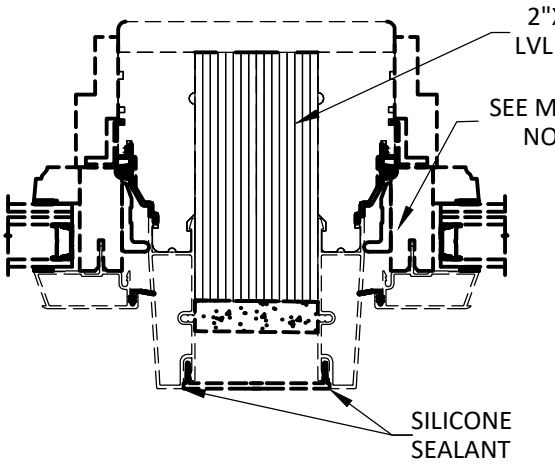

B
2
DUAL CASEMENT PICTURE
VERTICAL MULLION

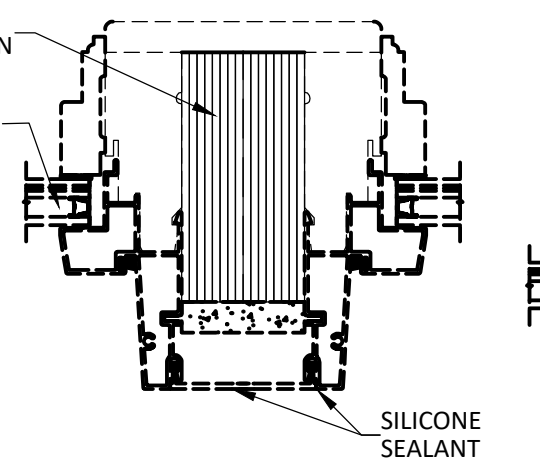

C
2
DUAL DIRECT SET
VERTICAL MULLION

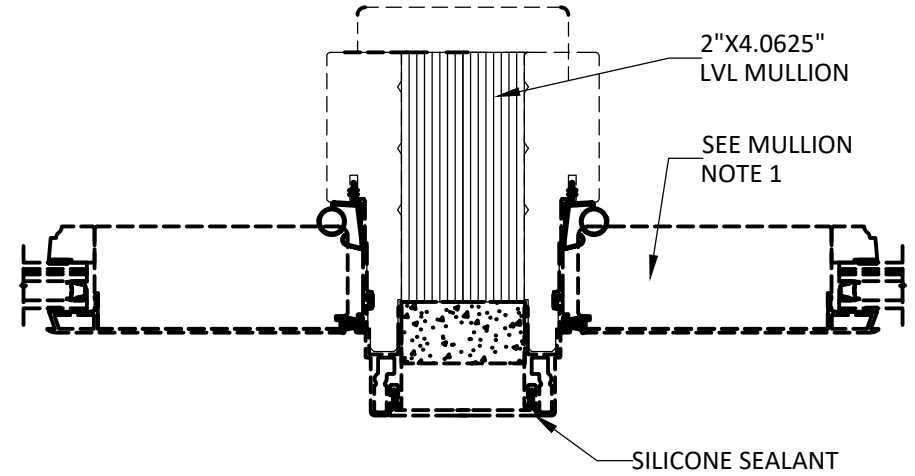

D
2
DUAL OUTSWING PATIO
VERTICAL MULLION

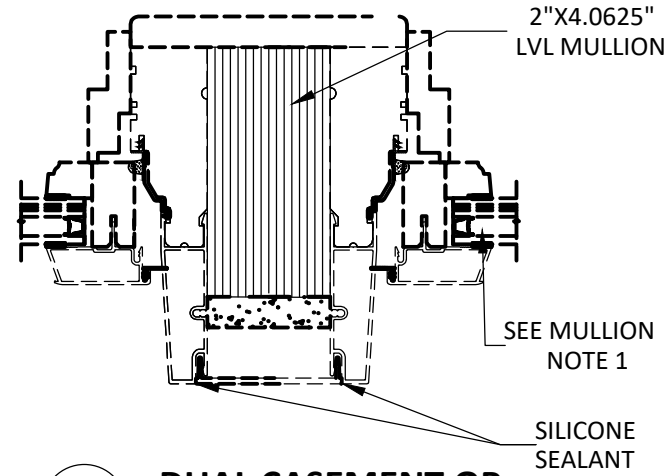

E
2
DUAL CASEMENT OP.
VERTICAL MULLION

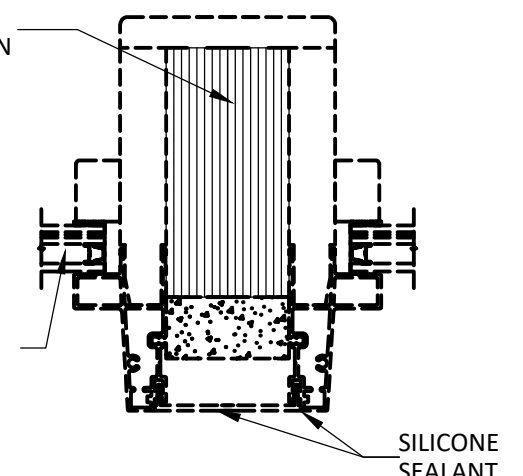

F
2
DUAL RADIUS
VERTICAL MULLION

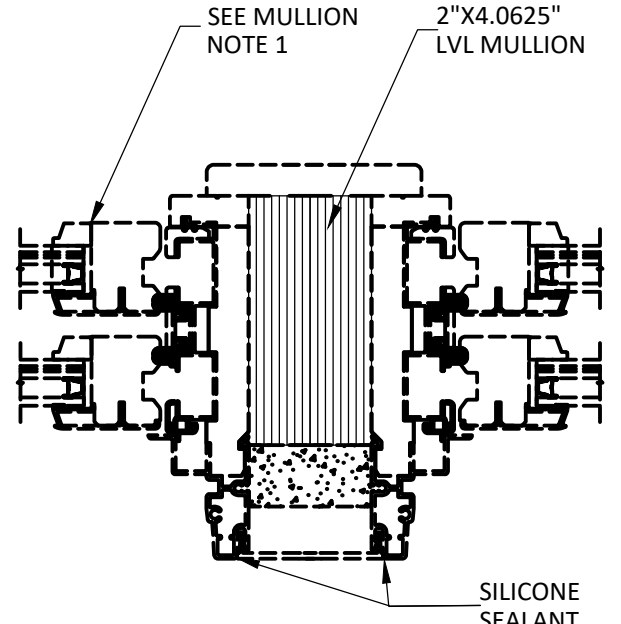

G
2
DUAL DOUBLE HUNG OP.
VERTICAL MULLION

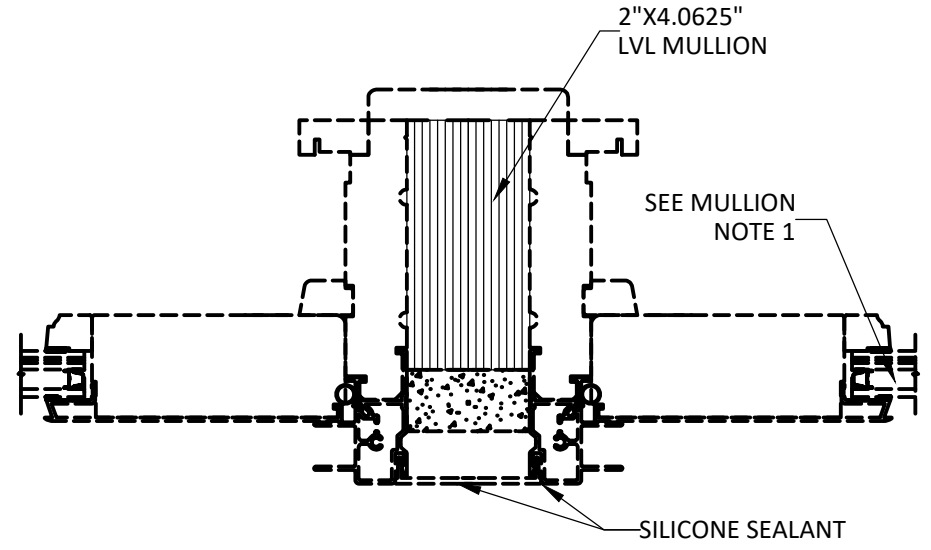

H
2
DUAL SLIDING PATIO
VERTICAL MULLION

- MULLION NOTES:**
1. WINDOW UNIT SHOWN ON THIS SHEET IS TYPICAL AND SHALL BE USED FOR DIAGRAMMATIC PURPOSES ONLY. ALL WINDOW AND DOOR PRODUCTS TO BE MULLED TO 2" LVL MULLION SHALL BE UNDER SEPARATE FL APPROVAL.
 2. MULLION SHOWN HEREIN MAY BE USED WITH APPROVED WINDOW OR DOOR PRODUCTS WHICH ARE COMPATIBLE WITH 2" LVL MULLION (E.G. WINDSOR WINDOWS PINNACLE CLAD SERIES PRODUCTS)
 3. INSTALLATION SHALL FOLLOW MANUFACTURER'S RECOMMENDATIONS FOR SEALING & ASSEMBLY. SHOULD MANUFACTURER'S INSTALLATION INSTRUCTION AND THOSE SHOWN HEREIN DEViate, THE DRAWINGS HEREIN SHALL GOVERN.
 4. TWO ANCHORS CLUSTERED TO EACH SIDE OF MULLION, SPACED 3" & 6" AWAY FROM MULLION AT BOTH ENDS.

TITLE:
PINNACLE CLAD 2" LVL MULLION (WZ3)(IMPACT)
VERTICAL MULLION ASSEMBLIES

PREPARED BY:
BUILDING DROPS, INC.
398 E. DANIA BEACH BLVD., STE. 338
DANIA BEACH, FL 33004
PH: (954)399-8478
FAX: (954)744-4738
WEB: www.buildingdrops.com

REMARKS	BY	DATE
FBC 2017 UPDATE	LS	06/17
FBC 2020 UPDATE	LL	11/20
FBC 2023 UPDATE	MG	02/23

THE INSTALLATION DETAILS DESCRIBED HEREIN ARE GENERIC AND MAY NOT REFLECT ACTUAL CONDITIONS FOR A SPECIFIC SITE. IF SITE CONDITIONS CAUSE INSTALLATION TO DEVIATE FROM THE REQUIREMENTS DETAILED HEREIN, A LICENSED ENGINEER OR ARCHITECT SHALL PREPARE SITE SPECIFIC DOCUMENTS FOR USE WITH THIS DOCUMENT.

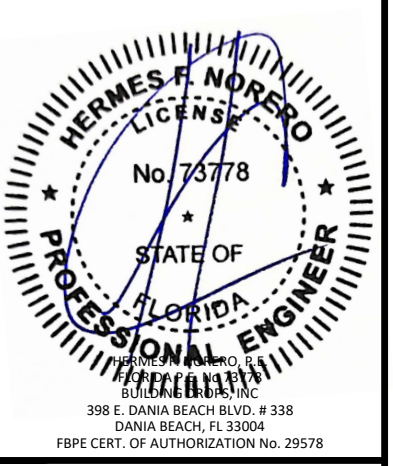

FL21905

DATE: **02.10.17**

DWG. BY: LA	CHK. BY: SM
--------------------	--------------------

SCALE: **NTS**

DWG. #: **WWD002**

SHEET: 2 OF 8

**WINDSOR WINDOWS
& DOORS**

900 S. 19TH STREET.
WEST DES MOINES, IA 50265
PH: (515)223-6660 FAX: (515)224-1938

TITLE:
PINNACLE CLAD 2" LVL MULLION
(WZ3)(IMPACT)
HORIZONTAL MULLION
ASSEMBLIES

PREPARED BY:
BUILDING DROPS, INC.
398 E. DANIA BEACH BLVD., STE. 338
DANIA BEACH, FL 33004
PH: (954)399-8478
FAX: (954)744-4738
WEB: www.buildingdrops.com



REMARKS	BY	DATE
FBC 2017 UPDATE	LS	06/17
FBC 2020 UPDATE	LL	11/20
FBC 2023 UPDATE	MG	02/23

THE INSTALLATION DETAILS DESCRIBED HEREIN ARE GENERIC AND MAY NOT REFLECT ACTUAL CONDITIONS FOR A SPECIFIC SITE. IF SITE CONDITIONS CAUSE INSTALLATION TO DEVIATE FROM THE REQUIREMENTS DETAILED HEREIN, A LICENSED ENGINEER OR ARCHITECT SHALL PREPARE SITE SPECIFIC DOCUMENTS FOR USE WITH THIS DOCUMENT.



FL21905

DATE: **02.10.17**

DWG. BY:
LA

CHK. BY:
SM

SCALE: **NTS**

DWG. #: **WWD002**

SHEET:

3

OF 8

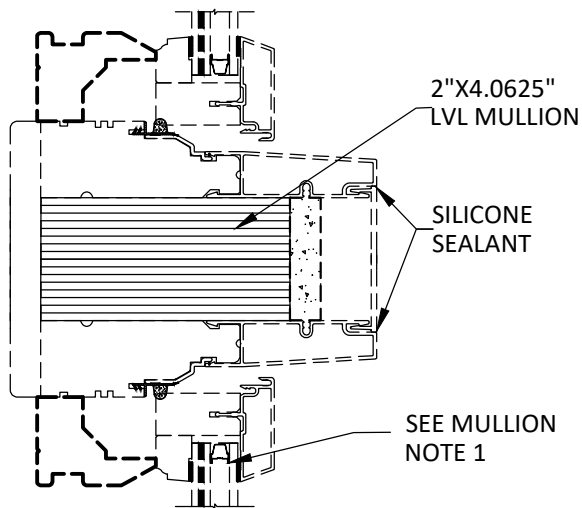

I 3
DUAL CASEMENT OP
HORIZONTAL MULLION

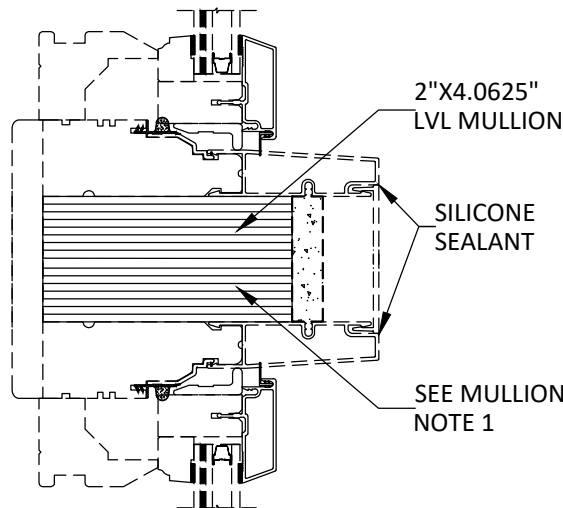

J 3
DUAL CASEMENT PIC
HORIZONTAL MULLION

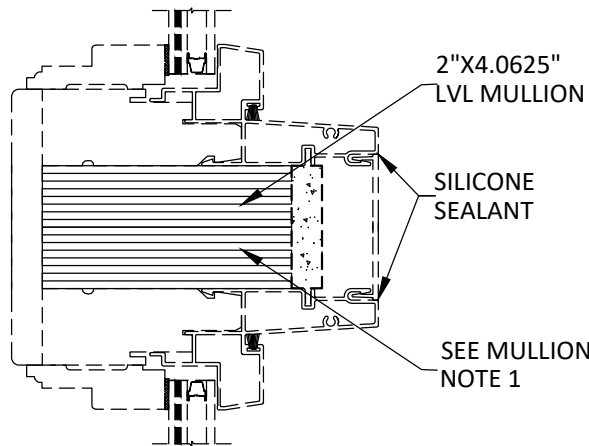

K 3
DUAL DIRECT SET
HORIZONTAL MULLION

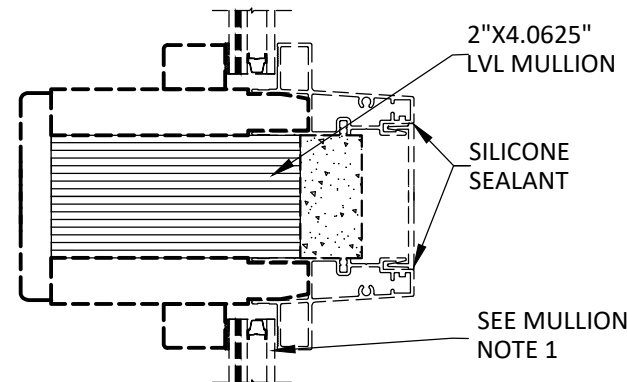

L 3
DUAL RADIUS
HORIZONTAL MULLION

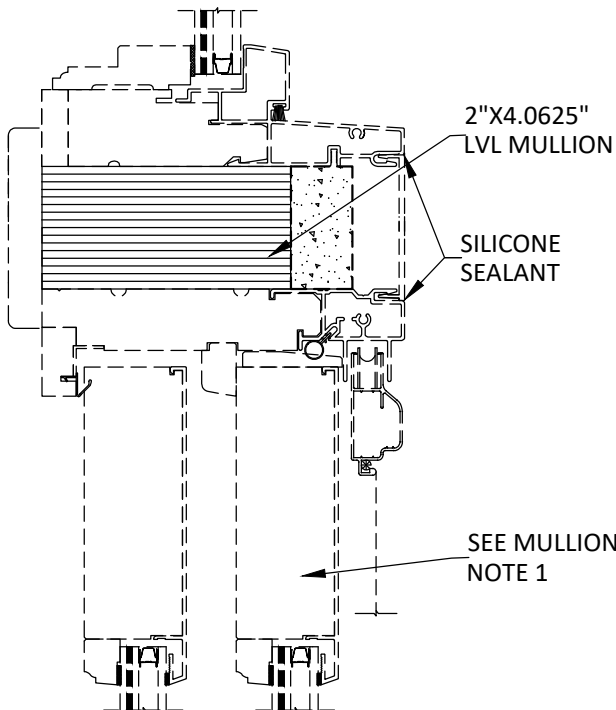

M 3
SLIDING - DIRECT SET
HORIZONTAL MULLION

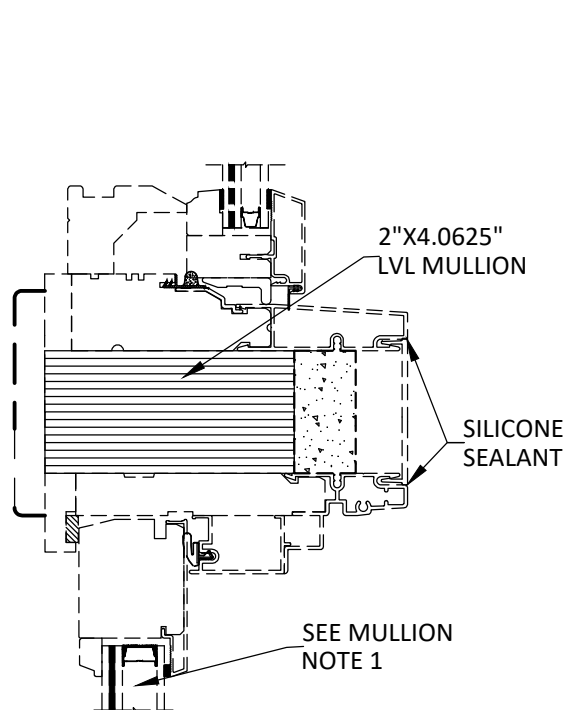

N 3
DH PIC - CASEMENT OP
HORIZONTAL MULLION

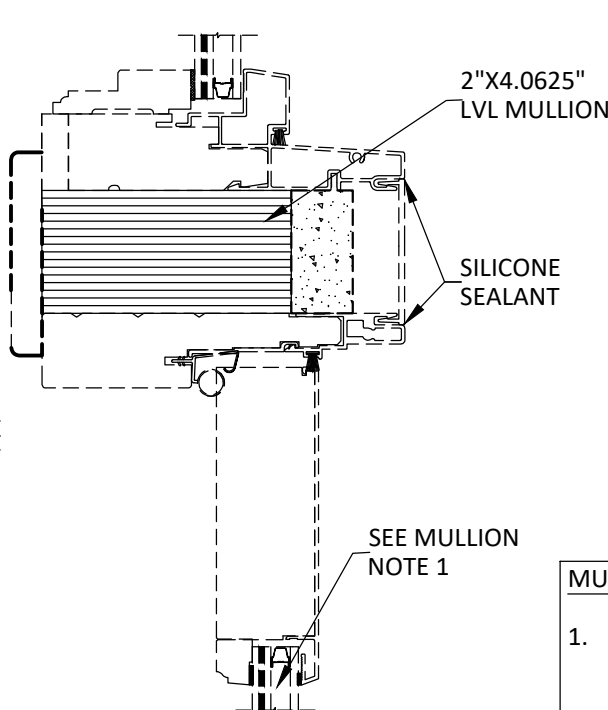

O 3
OUTSWING-CASEMENT OP
HORIZONTAL MULLION

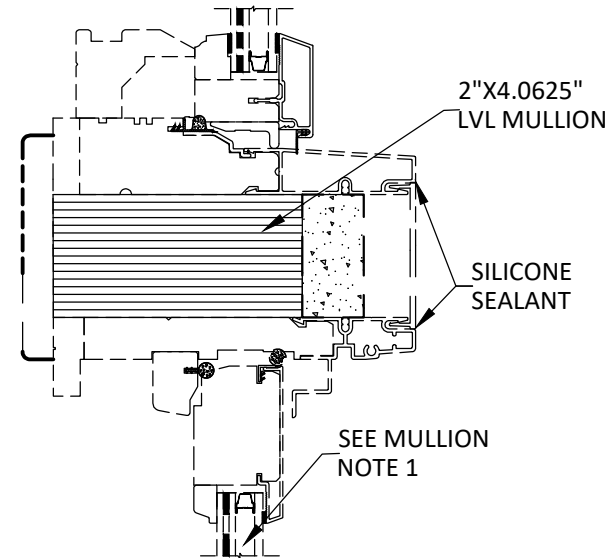

P 3
DH OP - CASEMENT OP
HORIZONTAL MULLION

MULLION NOTES:

- WINDOW UNIT SHOWN ON THIS SHEET IS TYPICAL AND SHALL BE USED FOR DIAGRAMMATIC PURPOSES ONLY. ALL WINDOW AND DOOR PRODUCTS TO BE MULLED TO 2" LVL MULLION SHALL BE UNDER SEPARATE FL APPROVAL.
- MULLION SHOWN HEREIN MAY BE USED WITH APPROVED WINDOW OR DOOR PRODUCTS WHICH ARE COMPATIBLE WITH 2" LVL MULLION (E.G. WINDSOR WINDOWS PINNACLE CLAD SERIES PRODUCTS)
- INSTALLATION SHALL FOLLOW MANUFACTURER'S RECOMMENDATIONS FOR SEALING & ASSEMBLY. SHOULD MANUFACTURER'S INSTALLATION INSTRUCTION AND THOSE SHOWN HEREIN DEVIATE, THE DRAWINGS HEREIN SHALL GOVERN.
- TWO ANCHORS CLUSTERED TO EACH SIDE OF MULLION, SPACED 3" & 6" AWAY FROM MULLION AT BOTH ENDS.

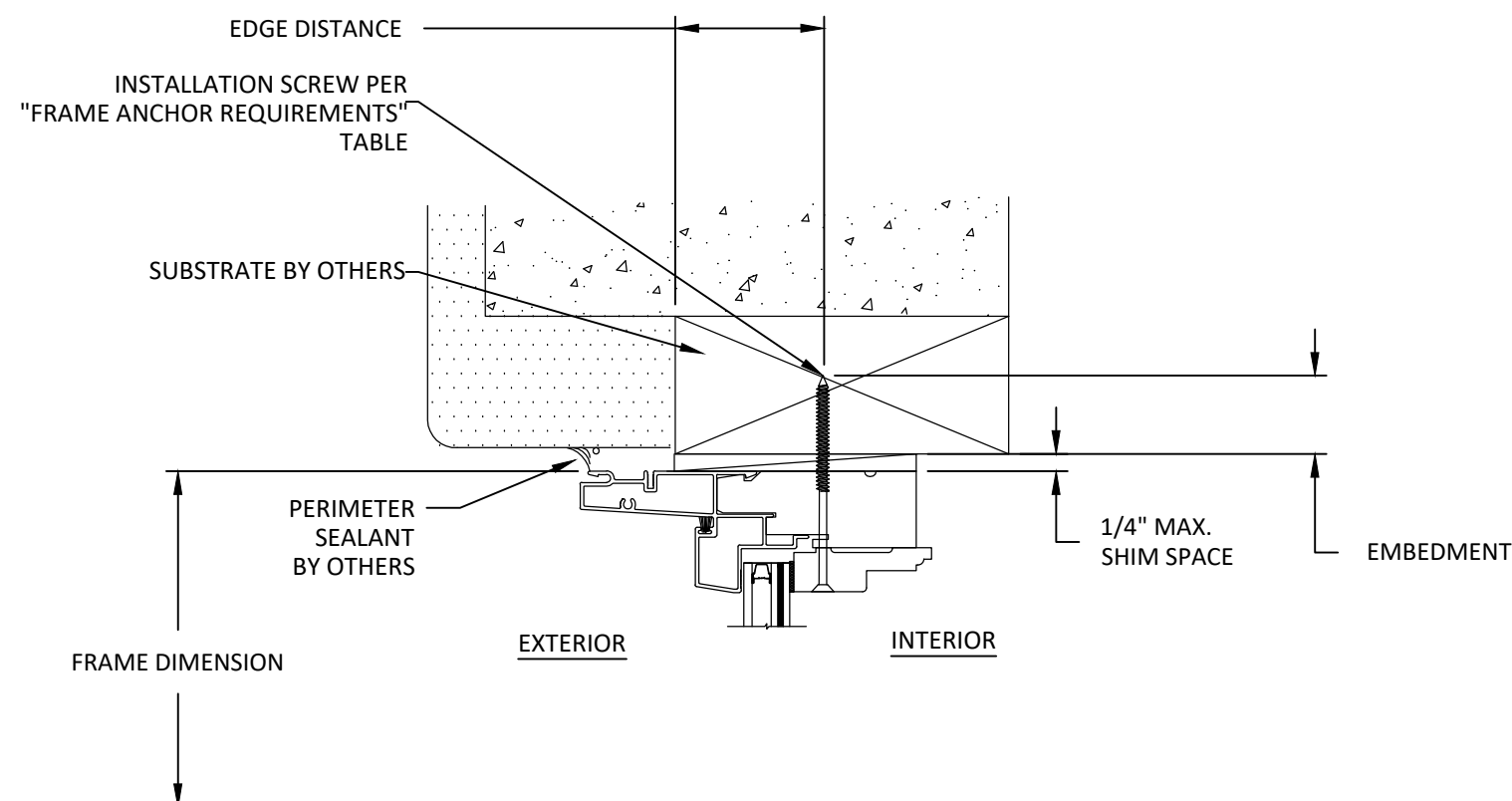

A
4

HEAD SECTION
THROUGH FRAME INSTALLATION
(SILL & SIDES ARE INSTALLED THE SAME)

FRAME ANCHOR REQUIREMENTS		
ANCHOR SUMMARY TABLE		
ANCHOR	EMBEDMENT	EDGE DISTANCE
#10 WOOD	1-1/4"	3/4"
#10 SMS	3 PITCHES OF THREAD	1/2"
1/4" ULTRACON	1-1/4"	2-1/2"

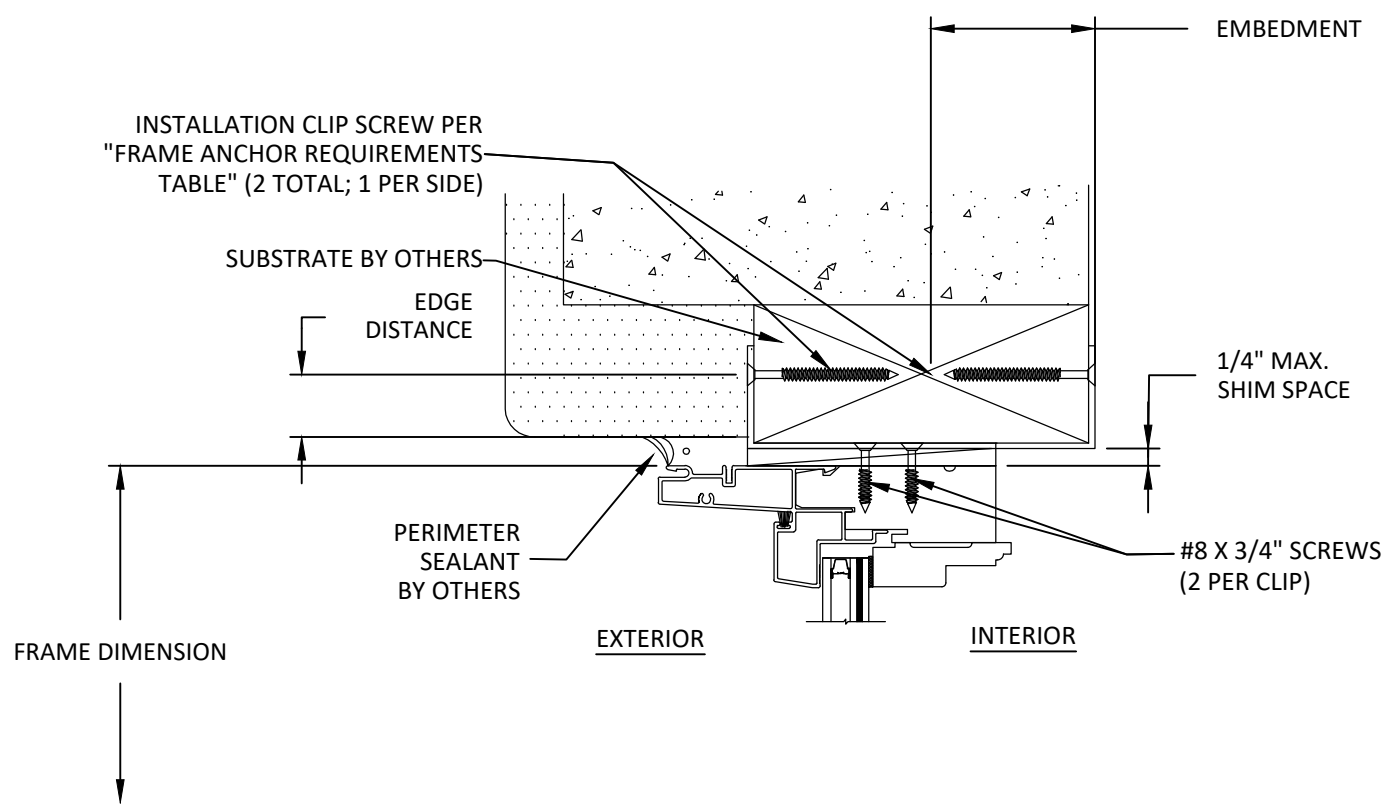

B
4

HEAD SECTION
STRAP INSTALLATION
(SILL & SIDES ARE INSTALLED THE SAME)



WINDSOR WINDOWS & DOORS
900 S. 19TH STREET.
WEST DES MOINES, IA 50265
PH: (515)223-6660 FAX: (515)224-1938

TITLE: PINNACLE CLAD 2" LVL MULLION (WZ3)(IMPACT)

INSTALLATION DETAILS

PREPARED BY: BUILDING DROPS, INC.

398 E. DANIA BEACH BLVD., STE. 338
DANIA BEACH, FL 33004
PH: (954)399-8478
FAX: (954)744-4738
WEB: www.buildingdrops.com

BUILDING DROPS

REMARKS	BY	DATE
FBC 2017 UPDATE	LS	06/17
FBC 2020 UPDATE	LL	11/20
FBC 2023 UPDATE	MG	02/23

THE INSTALLATION DETAILS DESCRIBED HERE IN ARE GENERIC AND MAY NOT REFLECT ACTUAL CONDITIONS FOR A SPECIFIC SITE. IF SITE CONDITIONS CAUSE INSTALLATION TO DEVIATE FROM THE REQUIREMENTS DETAILED HEREIN, A LICENSED ENGINEER OR ARCHITECT SHALL PREPARE SITE SPECIFIC DOCUMENTS FOR USE WITH THIS DOCUMENT.

HERMES F. NORERO
LICENSE
No. 73778
STATE OF
FLORIDA
PROFESSIONAL ENGINEER

HERMES F. NORERO, P.E.
BUILDING DROPS, INC.
398 E. DANIA BEACH BLVD. # 338
DANIA BEACH, FL 33004
FBPE CERT. OF AUTHORIZATION No. 29578

FL21905

DATE: 02.10.17

DWG. BY: LA	CHK. BY: SM
-------------	-------------

SCALE: NTS

DWG. #: WWD002

SHEET: 4 OF 8

2" LVL MULLION - THROUGH FRAME INSTALLATION
ONE-WAY CONFIGURATIONS (NO INTERMEDIATE MEMBERS)

Maximum design pressure capacity chart (psf):																		
L - Mull Length (in)	W - Tributary Width (in)																	
	21.0	24.0	27.0	30.0	33.0	36.0	39.0	42.0	45.0	48.0	51.0	54.0	57.0	60.0	66.0	72.0	78.0	84.0
18.0	150.0	150.0	150.0	150.0	150.0	150.0	150.0	150.0	150.0	150.0	150.0	150.0	150.0	150.0	150.0	150.0	150.0	150.0
24.0	150.0	150.0	150.0	150.0	150.0	150.0	150.0	150.0	150.0	150.0	150.0	150.0	150.0	150.0	150.0	150.0	150.0	150.0
30.0	150.0	150.0	150.0	150.0	150.0	150.0	150.0	150.0	150.0	150.0	150.0	150.0	150.0	150.0	150.0	150.0	150.0	150.0
36.0	150.0	150.0	150.0	150.0	150.0	150.0	150.0	150.0	150.0	150.0	150.0	150.0	150.0	150.0	150.0	150.0	150.0	150.0
42.0	150.0	150.0	150.0	150.0	150.0	150.0	150.0	150.0	150.0	150.0	150.0	150.0	150.0	150.0	150.0	150.0	150.0	150.0
48.0	150.0	150.0	150.0	150.0	150.0	150.0	150.0	150.0	150.0	150.0	150.0	150.0	150.0	150.0	150.0	150.0	150.0	150.0
54.0	150.0	150.0	150.0	150.0	150.0	150.0	150.0	150.0	150.0	150.0	150.0	150.0	150.0	150.0	150.0	150.0	150.0	150.0
60.0	150.0	150.0	150.0	150.0	150.0	150.0	146.3	141.1	137.0	133.8	131.4	129.7	128.7	128.4	128.4	128.4	128.4	128.4
66.0	150.0	150.0	150.0	150.0	141.5	133.8	127.5	122.3	118.1	114.7	111.9	109.8	108.1	107.0	106.1	106.1	106.1	106.1
72.0	150.0	150.0	146.3	135.2	126.2	118.9	112.9	107.9	103.8	100.3	97.5	95.1	93.2	91.7	89.8	89.2	89.2	89.2
78.0	150.0	145.9	132.7	122.3	113.9	107.0	101.3	96.5	92.5	89.2	86.3	83.9	81.9	80.3	77.8	76.4	76.0	76.0
84.0	149.7	133.8	121.4	111.7	103.8	97.3	91.9	87.4	83.5	80.3	77.5	75.1	73.1	71.3	68.7	66.9	65.9	65.5
90.0	138.4	123.5	111.9	102.7	95.3	89.2	84.1	79.8	76.1	73.0	70.3	67.9	65.9	64.2	61.4	59.4	58.1	57.3
96.0	128.7	114.7	103.8	95.1	88.1	82.3	77.5	73.4	69.9	66.9	63.9	61.2	58.9	56.9	53.6	51.1	49.4	48.2
101.0	120.7	106.2	95.0	86.1	78.9	72.9	67.9	63.7	60.1	56.9	54.2	51.9	49.8	48.1	45.1	42.9	41.2	40.0
108.0	98.5	86.6	77.4	70.1	64.1	59.2	55.1	51.6	48.6	46.0	43.8	41.8	40.1	38.6	36.0	34.1	32.5	31.4
114.0	83.6	73.5	65.6	59.4	54.3	50.1	46.6	43.6	41.0	38.8	36.9	35.2	33.7	32.4	30.2	28.4	27.0	25.9
120.0	71.6	62.9	56.1	50.8	46.4	42.8	39.8	37.2	35.0	33.0	31.4	29.9	28.6	27.4	25.5	23.9	22.7	21.7

NOTES:

- 'ONE-WAY' MULLIONS REFER TO EITHER VERTICAL SINGLE SPAN OR HORIZONTAL STACKED ASSEMBLIES SIMILAR TO THOSE DIAGRAMMED ON THIS SHEET.
- THE POSITIVE AND NEGATIVE DESIGN PRESSURE CHARTS ABOVE ARE APPLICABLE FOR 'STANDARD INSTALLATION' PROCEDURES, SEE DETAIL A/4.
- WINDOW OR DOORS SHALL BE UNDER SEPARATE APPROVAL.
- DESIGN PRESSURES SHALL BE GOVERNED BY THE LESSER OF THE MULLION ASSEMBLY (LISTED IN TABLE) OR INDIVIDUAL WINDOW OR DOOR UNIT UNDER SEPARATE APPROVAL.
- MULLIONS MAY BE USED IN ASSEMBLIES UTILIZING MORE THAN TWO WINDOW OR DOOR UNITS AND CAN BE USED FOR UNLIMITED NUMBER OF PANELS.

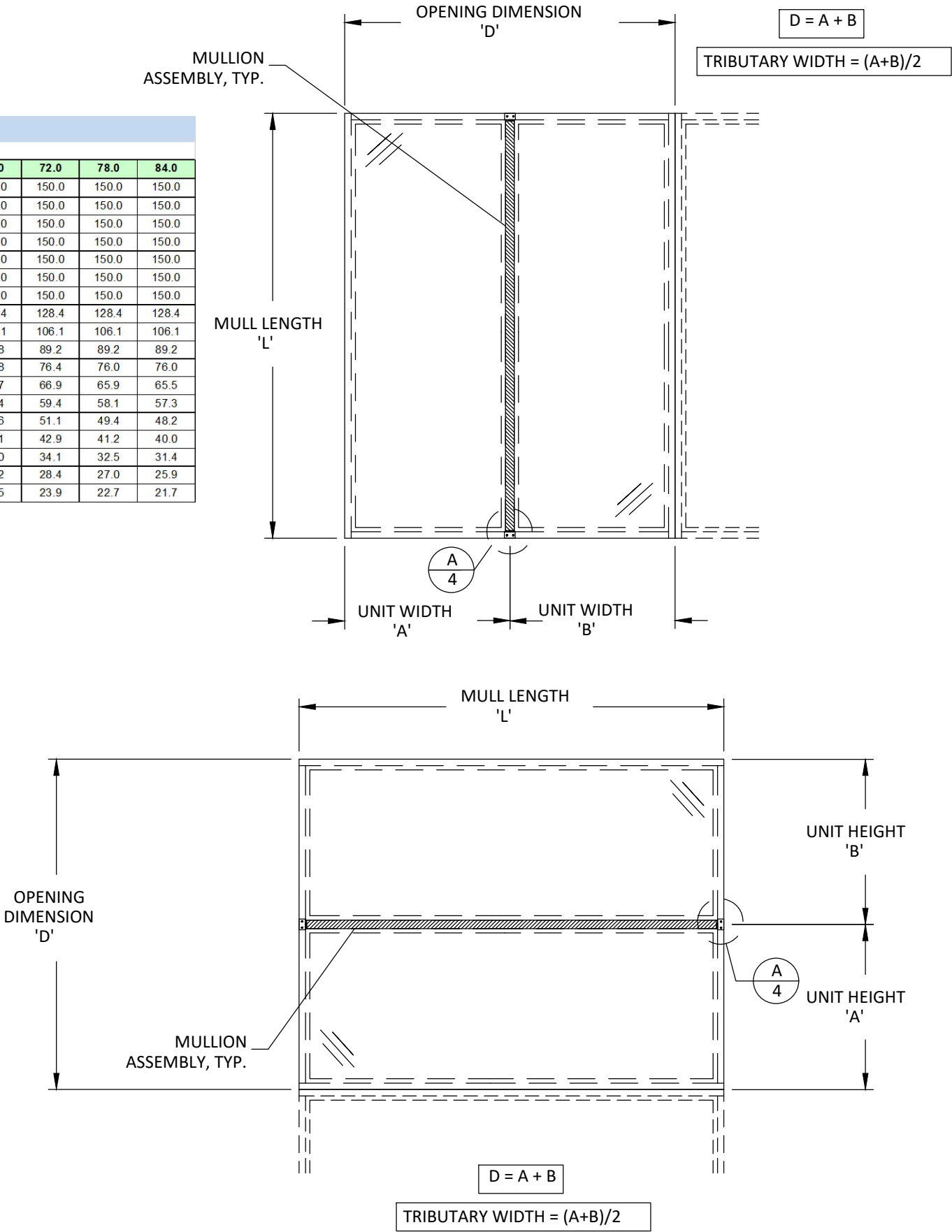

WINDSOR WINDOWS
& DOORS

900 S. 19TH STREET.
WEST DES MOINES, IA 50265
PH: (515)223-6660 FAX: (515)224-1938

TITLE:
PINNACLE CLAD 2" LVL MULLION
(WZ3)(IMPACT)

1-WAY DESIGN PRESSURE TABLES -
THROUGH FRAME INSTALLATION

PREPARED BY:

BUILDING DROPS, INC.
398 E. DANIA BEACH BLVD., STE. 338
DANIA BEACH, FL 33004
PH: (954)399-8478
FAX: (954)744-4738
WEB: www.buildingdrops.com



REMARKS	BY	DATE
FBC 2017 UPDATE	LS	06/17
FBC 2020 UPDATE	LL	11/20
FBC 2023 UPDATE	MG	02/23

THE INSTALLATION DETAILS DESCRIBED HEREIN ARE GENERIC AND MAY NOT REFLECT ACTUAL CONDITIONS FOR A SPECIFIC SITE. IF SITE CONDITIONS CAUSE INSTALLATION TO DEVIATE FROM THE REQUIREMENTS DETAILED HEREIN, A LICENSED ENGINEER OR ARCHITECT SHALL PREPARE SITE SPECIFIC DOCUMENTS FOR USE WITH THIS DOCUMENT.

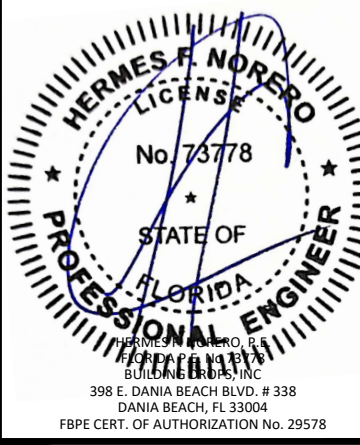

FL21905

DATE:	02.10.17
DWG. BY:	LA
CHK. BY:	SM
SCALE:	NTS
DWG. #:	WWD002

SHEET:

5

OF 8

2" LVL MULLION - THROUGH FRAME INSTALLATION
TWO-WAY CONFIGURATIONS (WITH INTERMEDIATE MEMBERS)



WINDSOR WINDOWS
& DOORS

900 S. 19TH STREET.
WEST DES MOINES, IA 50265
PH: (515)223-6660 FAX: (515)224-1938

TITLE:
PINNACLE CLAD 2" LVL MULLION
(WZ3)(IMPACT)
2-WAY DESIGN PRESSURE TABLES -
THROUGH FRAME INSTALLATION

PREPARED BY:
BUILDING DROPS, INC.
398 E. DANIA BEACH BLVD., STE. 338
DANIA BEACH, FL 33004
PH: (954)399-8478
FAX: (954)744-4738
WEB: www.buildingdrops.com

Maximum design pressure capacity chart (psf):																		
L - Mull Length (in)	W - Tributary Width (in)																	
	21.0	24.0	27.0	30.0	33.0	36.0	39.0	42.0	45.0	48.0	51.0	54.0	57.0	60.0	66.0	72.0	78.0	84.0
18.0	150.0	150.0	150.0	150.0	150.0	150.0	150.0	150.0	150.0	150.0	150.0	150.0	150.0	150.0	150.0	150.0	150.0	150.0
24.0	150.0	150.0	150.0	150.0	150.0	150.0	150.0	150.0	150.0	150.0	150.0	150.0	150.0	150.0	145.9	133.8	123.5	114.7
30.0	150.0	150.0	150.0	150.0	150.0	150.0	150.0	150.0	150.0	150.0	150.0	142.7	135.2	128.4	116.7	107.0	98.8	91.7
36.0	150.0	150.0	150.0	150.0	150.0	150.0	150.0	150.0	150.0	142.7	133.8	125.9	118.9	112.6	107.0	97.3	89.2	82.3
42.0	150.0	150.0	150.0	150.0	150.0	150.0	141.1	131.0	122.3	114.7	107.9	101.9	96.5	91.7	83.4	76.4	70.6	65.5
48.0	150.0	150.0	150.0	150.0	145.9	133.8	123.5	114.7	107.0	100.3	94.4	89.2	84.5	80.3	73.0	66.9	61.7	57.3
54.0	150.0	150.0	150.0	142.7	129.7	118.9	109.8	101.9	95.1	89.2	83.9	79.3	75.1	71.3	64.9	59.4	54.9	51.0
60.0	150.0	150.0	142.7	128.4	116.7	107.0	98.8	91.7	85.6	80.3	75.5	71.3	67.6	64.2	58.4	53.5	49.4	45.9
66.0	150.0	145.9	129.7	116.7	106.1	97.3	89.8	83.4	77.8	73.0	68.7	64.9	61.4	58.4	53.1	48.6	44.9	41.7
72.0	150.0	133.8	118.9	107.0	97.3	89.2	82.3	76.4	71.3	66.9	62.9	59.4	56.3	53.5	48.6	44.6	41.2	38.2
78.0	141.1	123.5	109.8	98.8	89.8	82.3	76.0	70.6	65.9	61.7	58.1	54.9	52.0	49.4	44.9	41.2	38.0	35.3
84.0	131.0	114.7	101.9	91.7	83.4	76.4	70.6	65.5	61.1	57.3	54.0	51.0	48.3	45.9	41.7	38.2	35.3	32.8
90.0	122.3	107.0	95.1	85.6	77.8	71.3	65.9	61.1	57.1	53.5	50.4	47.6	45.1	42.8	38.9	35.7	32.9	30.6
96.0	114.7	100.3	89.2	80.3	73.0	66.9	61.7	57.3	53.5	50.2	47.2	44.6	42.2	40.1	36.5	33.4	30.9	28.7
101.0	109.0	95.4	84.8	76.3	69.3	63.6	58.7	54.5	50.9	47.7	44.9	42.4	40.1	38.1	34.7	31.8	29.3	27.2
108.0	97.0	84.9	75.5	67.9	61.7	56.6	52.2	48.5	45.3	42.5	40.0	37.7	35.7	34.0	30.9	28.3	26.1	24.3
114.0	82.5	72.2	64.2	57.8	52.5	48.1	44.4	41.3	38.5	36.1	34.0	32.1	30.4	28.9	26.3	24.1	22.2	20.6
120.0	70.7	61.9	55.0	49.5	45.0	41.3	38.1	35.4	33.0	30.9	29.1	27.5	26.1	24.8	22.5	20.6	19.0	17.7

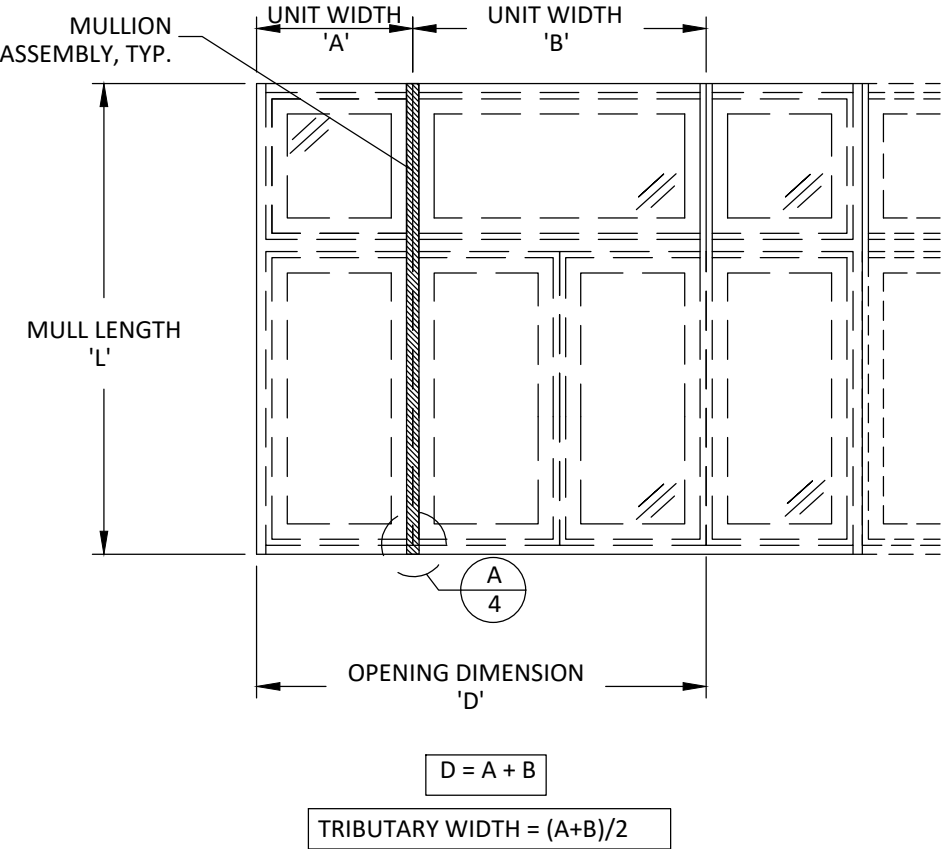
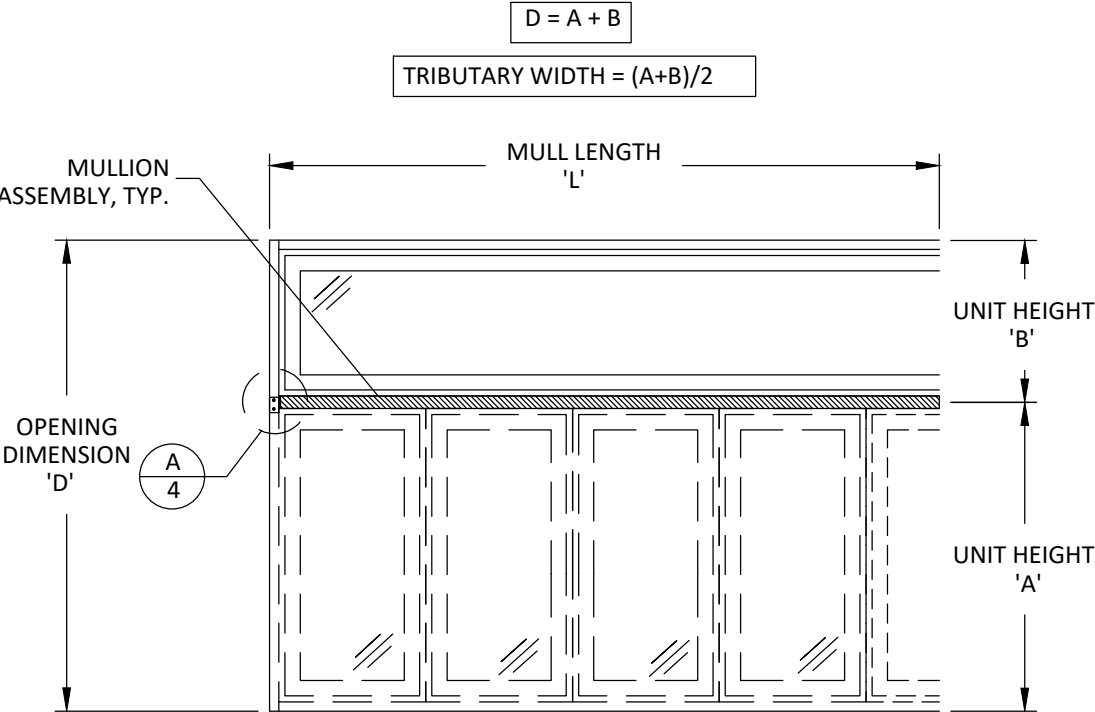

- NOTES:
- 'TWO-WAY' MULLIONS REFER TO EITHER VERTICAL OR HORIZONTAL WITH INTERMEDIATE MEMBERS SIMILAR TO THOSE DIAGRAMMED ON THIS SHEET.
 - THE POSITIVE AND NEGATIVE DESIGN PRESSURE CHARTS ABOVE ARE APPLICABLE FOR 'STANDARD INSTALLATION' PROCEDURES, SEE DETAIL A/4.
 - WINDOW OR DOORS SHALL BE UNDER SEPARATE APPROVAL.
 - DESIGN PRESSURES SHALL BE GOVERNED BY THE LESSER OF THE MULLION ASSEMBLY (LISTED IN TABLE) OR INDIVIDUAL WINDOW OR DOOR UNIT UNDER SEPARATE APPROVAL.
 - MULLIONS MAY BE USED IN ASSEMBLIES UTILIZING MORE THAN TWO WINDOW OR DOOR UNITS AND CAN BE USED FOR UNLIMITED NUMBER OF PANELS.

THE INSTALLATION DETAILS DESCRIBED HEREIN ARE GENERIC AND MAY NOT REFLECT ACTUAL CONDITIONS FOR A SPECIFIC SITE. IF SITE CONDITIONS CAUSE INSTALLATION TO DEVIATE FROM THE REQUIREMENTS DETAILED HEREIN, A LICENSED ENGINEER OR ARCHITECT SHALL PREPARE SITE SPECIFIC DOCUMENTS FOR USE WITH THIS DOCUMENT.

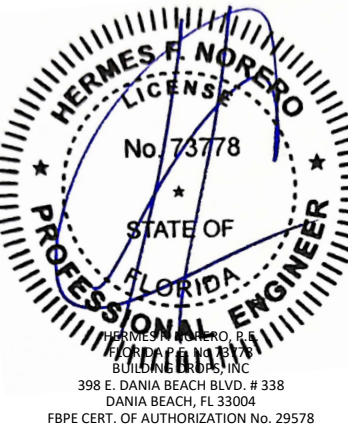

FL21905

DATE: 02.10.17

DWG. BY: LA

CHK. BY: SM

SCALE: NTS

DWG. #: WWD002

SHEET:

2" LVL MULLION - STRAP INSTALLATION
ONE-WAY CONFIGURATIONS (NO INTERMEDIATE MEMBERS)

Maximum design pressure capacity chart (psf):																			
L - Mull Length (in)	W - Tributary Width (in)																		
	21.0	24.0	27.0	30.0	33.0	36.0	39.0	42.0	45.0	48.0	51.0	54.0	57.0	60.0	66.0	72.0	78.0	84.0	
18.0	150.0	150.0	150.0	150.0	150.0	150.0	150.0	150.0	150.0	150.0	150.0	150.0	150.0	150.0	150.0	150.0	150.0	150.0	150.0
24.0	150.0	150.0	150.0	150.0	150.0	150.0	150.0	150.0	150.0	150.0	150.0	150.0	150.0	150.0	150.0	150.0	150.0	150.0	150.0
30.0	150.0	150.0	150.0	150.0	150.0	150.0	150.0	150.0	150.0	150.0	150.0	150.0	150.0	150.0	150.0	150.0	150.0	150.0	150.0
36.0	150.0	150.0	150.0	150.0	150.0	150.0	150.0	150.0	150.0	150.0	150.0	150.0	150.0	150.0	150.0	150.0	150.0	150.0	150.0
42.0	150.0	150.0	150.0	150.0	150.0	150.0	150.0	150.0	150.0	150.0	150.0	150.0	150.0	150.0	150.0	150.0	150.0	150.0	150.0
48.0	150.0	150.0	150.0	150.0	150.0	150.0	150.0	150.0	150.0	150.0	150.0	150.0	150.0	150.0	150.0	150.0	150.0	150.0	150.0
54.0	150.0	150.0	150.0	150.0	150.0	150.0	150.0	150.0	150.0	150.0	150.0	150.0	150.0	150.0	150.0	150.0	150.0	150.0	150.0
60.0	150.0	150.0	150.0	150.0	150.0	150.0	146.3	141.1	137.0	133.8	131.4	129.7	128.7	128.4	128.4	128.4	128.4	128.4	128.4
66.0	150.0	150.0	150.0	150.0	141.5	133.8	127.5	122.3	118.1	114.7	111.9	109.8	108.1	107.0	106.1	106.1	106.1	106.1	106.1
72.0	150.0	150.0	146.3	135.2	126.2	118.9	112.9	107.9	103.8	100.3	97.5	95.1	93.2	91.7	89.8	89.2	89.2	89.2	89.2
78.0	150.0	145.9	132.7	122.3	113.9	107.0	101.3	96.5	92.5	89.2	86.3	83.9	81.9	80.3	77.8	76.4	76.0	76.0	76.0
84.0	149.7	133.8	121.4	111.7	103.8	97.3	91.9	87.4	83.5	80.3	77.5	75.1	73.1	71.3	68.7	66.9	65.9	65.5	65.5
90.0	138.4	123.5	111.9	102.7	95.3	89.2	84.1	79.8	76.1	73.0	70.3	67.9	65.9	64.2	61.4	59.4	58.1	57.3	57.3
96.0	128.7	114.7	103.8	95.1	88.1	82.3	77.5	73.4	69.9	66.9	63.9	61.2	58.9	56.9	53.6	51.1	49.4	48.2	48.2
101.0	120.7	106.2	95.0	86.1	78.9	72.9	67.9	63.7	60.1	56.9	54.2	51.9	49.8	48.1	45.1	42.9	41.2	40.0	40.0
108.0	98.5	86.6	77.4	70.1	64.1	59.2	55.1	51.6	48.6	46.0	43.8	41.8	40.1	38.6	36.0	34.1	32.5	31.4	31.4
114.0	83.6	73.5	65.6	59.4	54.3	50.1	46.6	43.6	41.0	38.8	36.9	35.2	33.7	32.4	30.2	28.4	27.0	25.9	25.9
120.0	71.6	62.9	56.1	50.8	46.4	42.8	39.8	37.2	35.0	33.0	31.4	29.9	28.6	27.4	25.5	23.9	22.7	21.7	21.7

NOTES:

- 'ONE-WAY' MULLIONS REFER TO EITHER VERTICAL SINGLE SPAN OR HORIZONTAL STACKED ASSEMBLIES SIMILAR TO THOSE DIAGRAMMED ON THIS SHEET.
- THE POSITIVE AND NEGATIVE DESIGN PRESSURE CHARTS ABOVE ARE APPLICABLE FOR 'ALTERNATE INSTALLATION' PROCEDURES, SEE DETAIL B/4.
- WINDOW OR DOORS SHALL BE UNDER SEPARATE APPROVAL.
- DESIGN PRESSURES SHALL BE GOVERNED BY THE LESSER OF THE MULLION ASSEMBLY (LISTED IN TABLE) OR INDIVIDUAL WINDOW OR DOOR UNIT UNDER SEPARATE APPROVAL.
- MULLIONS MAY BE USED IN ASSEMBLIES UTILIZING MORE THAN TWO WINDOW OR DOOR UNITS AND CAN BE USED FOR UNLIMITED NUMBER OF PANELS.

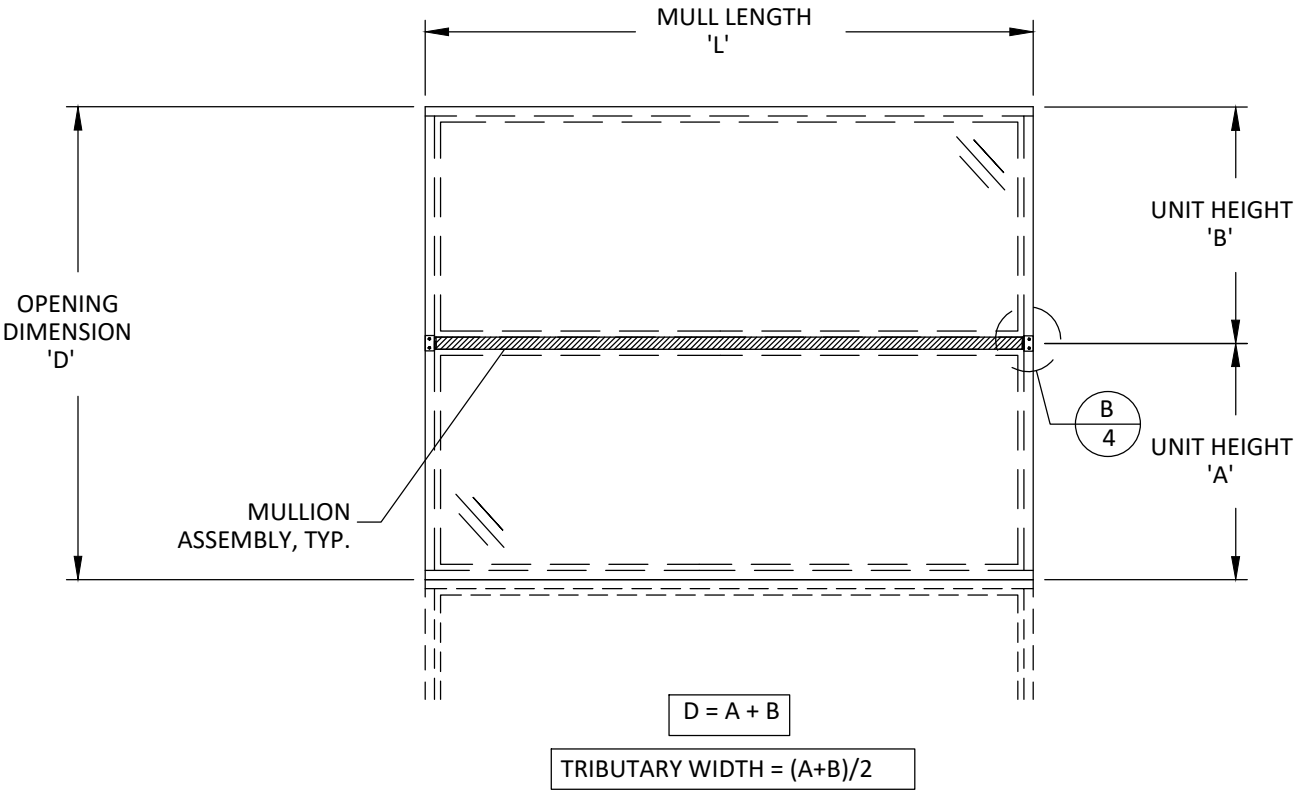
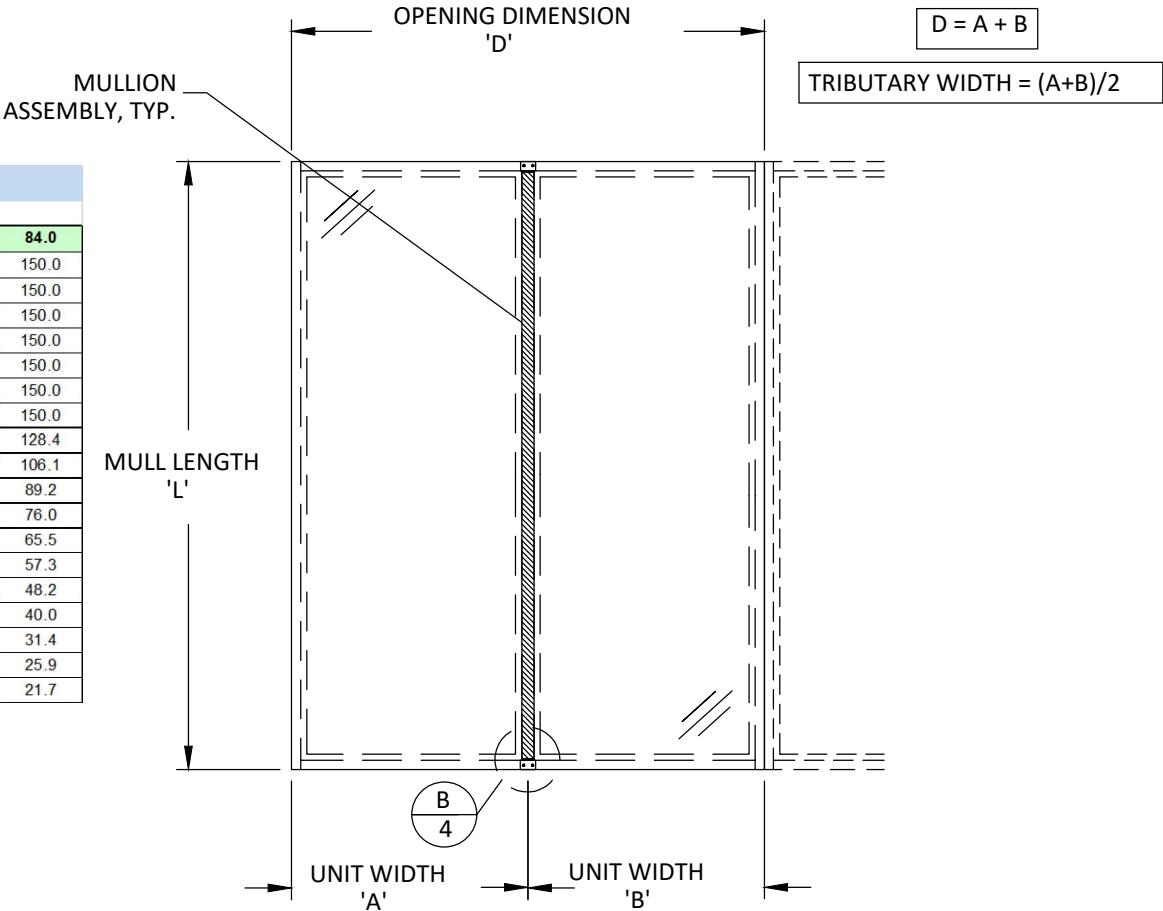

WINDSOR WINDOWS
& DOORS

900 S. 19TH STREET.
WEST DES MOINES, IA 50265
PH: (515)223-6660 FAX: (515)224-1938

TITLE:
PINNACLE CLAD 2" LVL MULLION
(WZ3)(IMPACT)
1-WAY DESIGN PRESSURE TABLES -
STRAP INSTALLATION

PREPARED BY:
BUILDING DROPS, INC.
398 E. DANIA BEACH BLVD., STE. 338
DANIA BEACH, FL 33004
PH: (954)399-8478
FAX: (954)744-4738
WEB: www.buildingdrops.com

REMARKS	BY	DATE
FBC 2017 UPDATE	LS	06/17
FBC 2020 UPDATE	LL	11/20
FBC 2023 UPDATE	MG	02/23

THE INSTALLATION DETAILS DESCRIBED HEREIN ARE GENERIC AND MAY NOT REFLECT ACTUAL CONDITIONS FOR A SPECIFIC SITE. IF SITE CONDITIONS CAUSE INSTALLATION TO DEVIATE FROM THE REQUIREMENTS DETAILED HEREIN, A LICENSED ENGINEER OR ARCHITECT SHALL PREPARE SITE SPECIFIC DOCUMENTS FOR USE WITH THIS DOCUMENT.

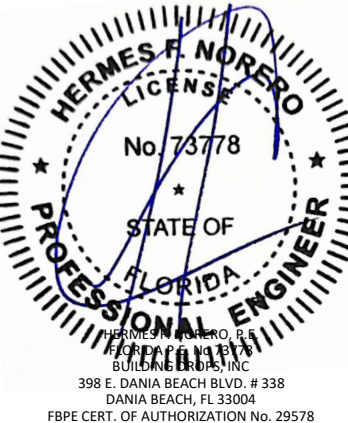

FL21905

DATE: 02.10.17

DWG. BY:
LA

CHK. BY:
SM

SCALE: NTS

DWG. #: WWD002

SHEET:

7

OF 8

2" LVL MULLION - STRAP INSTALLATION
TWO-WAY CONFIGURATIONS (WITH INTERMEDIATE MEMBERS)



WINDSOR WINDOWS
& DOORS

900 S. 19TH STREET.
WEST DES MOINES, IA 50265
PH: (515)223-6660 FAX: (515)224-1938

TITLE:
PINNACLE CLAD 2" LVL MULLION
(WZ3)(IMPACT)
2-WAY DESIGN PRESSURE TABLES -
STRAP INSTALLATION

PREPARED BY:
BUILDING DROPS, INC.
398 E. DANIA BEACH BLVD., STE. 338
DANIA BEACH, FL 33004
PH: (954)399-8478
FAX: (954)744-4738
WEB: www.buildingdrops.com

Maximum design pressure capacity chart (psf):																		
L - Mull Length (in)	W - Tributary Width (in)																	
	21.0	24.0	27.0	30.0	33.0	36.0	39.0	42.0	45.0	48.0	51.0	54.0	57.0	60.0	66.0	72.0	78.0	84.0
18.0	150.0	150.0	150.0	150.0	150.0	150.0	150.0	150.0	150.0	150.0	150.0	150.0	150.0	150.0	150.0	150.0	150.0	150.0
24.0	150.0	150.0	150.0	150.0	150.0	150.0	150.0	150.0	150.0	150.0	150.0	150.0	150.0	150.0	145.9	133.8	123.5	114.7
30.0	150.0	150.0	150.0	150.0	150.0	150.0	150.0	150.0	150.0	150.0	150.0	142.7	135.2	128.4	116.7	107.0	98.8	91.7
36.0	150.0	150.0	150.0	150.0	150.0	150.0	150.0	150.0	142.7	133.8	125.9	118.9	112.6	107.0	97.3	89.2	82.3	76.4
42.0	150.0	150.0	150.0	150.0	150.0	150.0	141.1	131.0	122.3	114.7	107.9	101.9	96.5	91.7	83.4	76.4	70.6	65.5
48.0	150.0	150.0	150.0	150.0	145.9	133.8	123.5	114.7	107.0	100.3	94.4	89.2	84.5	80.3	73.0	66.9	61.7	57.3
54.0	150.0	150.0	150.0	142.7	129.7	118.9	109.8	101.9	95.1	89.2	83.9	79.3	75.1	71.3	64.9	59.4	54.9	51.0
60.0	150.0	150.0	142.7	128.4	116.7	107.0	98.8	91.7	85.6	80.3	75.5	71.3	67.6	64.2	58.4	53.5	49.4	45.9
66.0	150.0	145.9	129.7	116.7	106.1	97.3	89.8	83.4	77.8	73.0	68.7	64.9	61.4	58.4	53.1	48.6	44.9	41.7
72.0	150.0	133.8	118.9	107.0	97.3	89.2	82.3	76.4	71.3	66.9	62.9	59.4	56.3	53.5	48.6	44.6	41.2	38.2
78.0	141.1	123.5	109.8	98.8	89.8	82.3	76.0	70.6	65.9	61.7	58.1	54.9	52.0	49.4	44.9	41.2	38.0	35.3
84.0	131.0	114.7	101.9	91.7	83.4	76.4	70.6	65.5	61.1	57.3	54.0	51.0	48.3	45.9	41.7	38.2	35.3	32.8
90.0	122.3	107.0	95.1	85.6	77.8	71.3	65.9	61.1	57.1	53.5	50.4	47.6	45.1	42.8	38.9	35.7	32.9	30.6
96.0	114.7	100.3	89.2	80.3	73.0	66.9	61.7	57.3	53.5	50.2	47.2	44.6	42.2	40.1	36.5	33.4	30.9	28.7
101.0	109.0	95.4	84.8	76.3	69.3	63.6	58.7	54.5	50.9	47.7	44.9	42.4	40.1	38.1	34.7	31.8	29.3	27.2
108.0	97.0	84.9	75.5	67.9	61.7	56.6	52.2	48.5	45.3	42.5	40.0	37.7	35.7	34.0	30.9	28.3	26.1	24.3
114.0	82.5	72.2	64.2	57.8	52.5	48.1	44.4	41.3	38.5	36.1	34.0	32.1	30.4	28.9	26.3	24.1	22.2	20.6
120.0	70.7	61.9	55.0	49.5	45.0	41.3	38.1	35.4	33.0	30.9	29.1	27.5	26.1	24.8	22.5	20.6	19.0	17.7

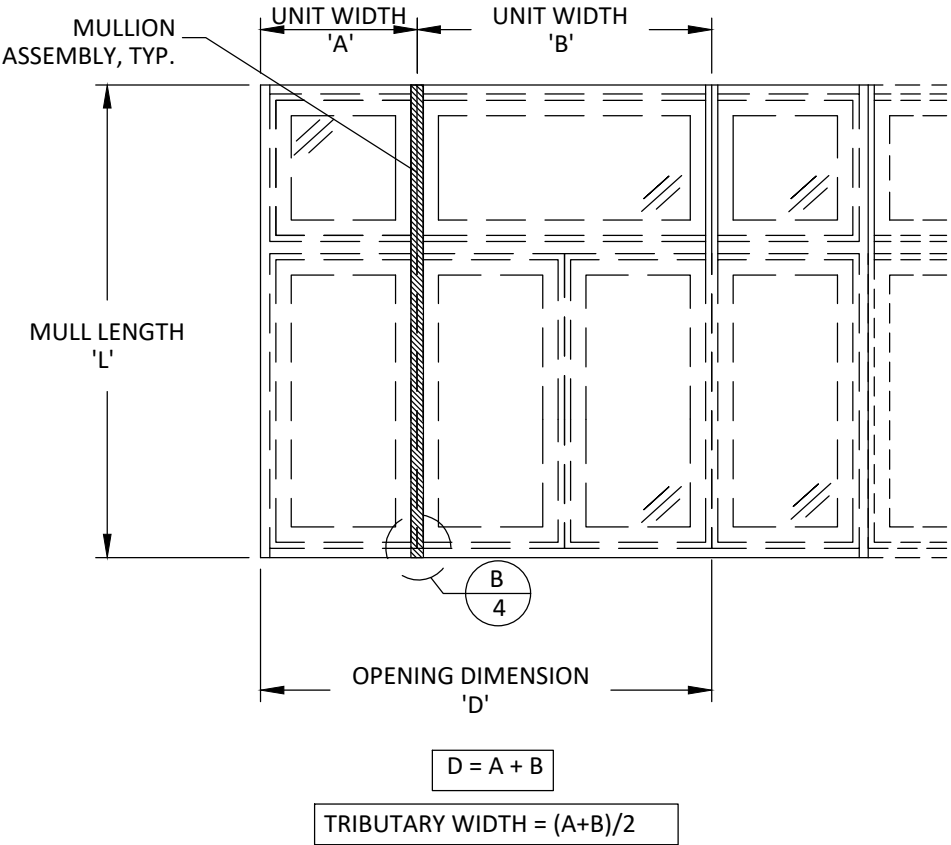
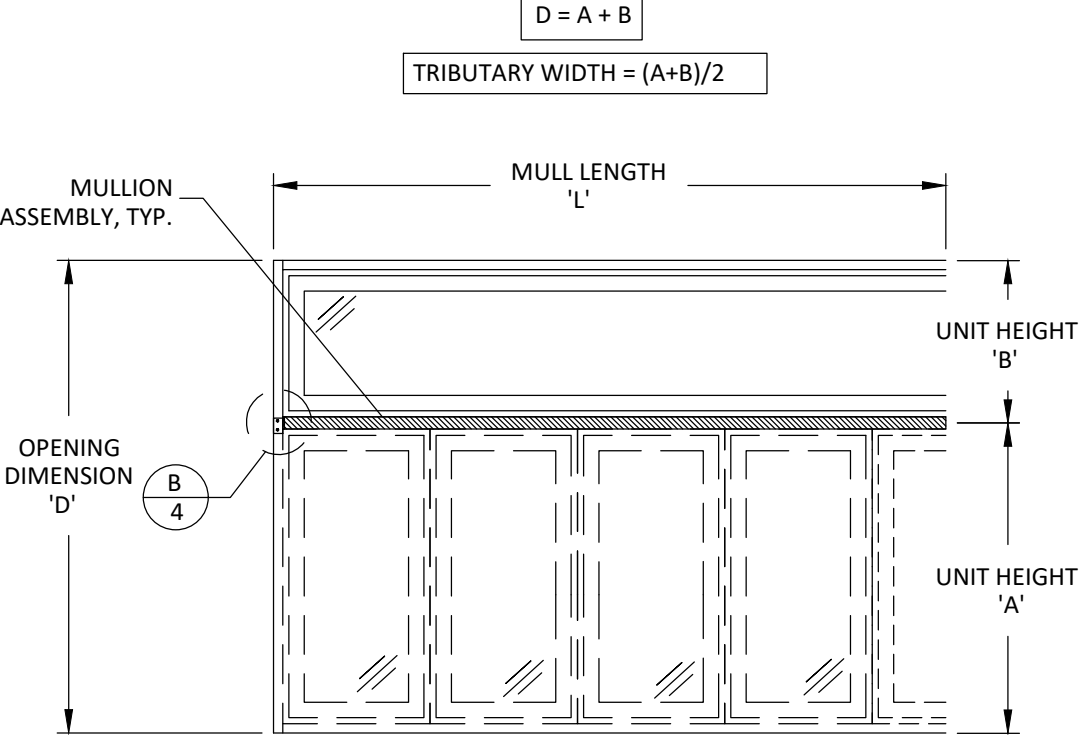

- NOTES:
- 'TWO-WAY' MULLIONS REFER TO EITHER VERTICAL OR HORIZONTAL WITH INTERMEDIATE MEMBERS SIMILAR TO THOSE DIAGRAMMED ON THIS SHEET.
 - THE POSITIVE AND NEGATIVE DESIGN PRESSURE CHARTS ABOVE ARE APPLICABLE FOR 'STANDARD INSTALLATION' PROCEDURES, SEE DETAIL B/4.
 - WINDOW OR DOORS SHALL BE UNDER SEPARATE APPROVAL.
 - DESIGN PRESSURES SHALL BE GOVERNED BY THE LESSER OF THE MULLION ASSEMBLY (LISTED IN TABLE) OR INDIVIDUAL WINDOW OR DOOR UNIT UNDER SEPARATE APPROVAL.
 - MULLIONS MAY BE USED IN ASSEMBLIES UTILIZING MORE THAN TWO WINDOW OR DOOR UNITS AND CAN BE USED FOR UNLIMITED NUMBER OF PANELS.

THE INSTALLATION DETAILS DESCRIBED HERE IN ARE GENERIC AND MAY NOT REFLECT ACTUAL CONDITIONS FOR A SPECIFIC SITE. IF SITE CONDITIONS CAUSE INSTALLATION TO DEVIATE FROM THE REQUIREMENTS DETAILED HEREIN, A LICENSED ENGINEER OR ARCHITECT SHALL PREPARE SITE SPECIFIC DOCUMENTS FOR USE WITH THIS DOCUMENT.

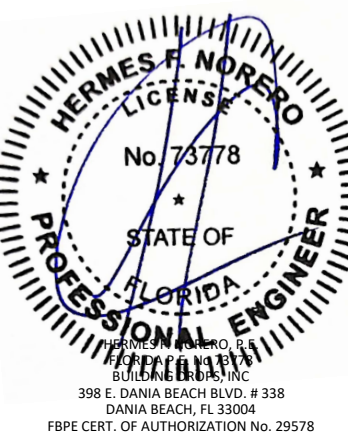

FL21905

DATE: 02.10.17

DWG. BY: LA

CHK. BY: SM

SCALE: NTS

DWG. #: WWD002

SHEET: 8 OF 8